

Standard type made of iglidur® J ► page 109

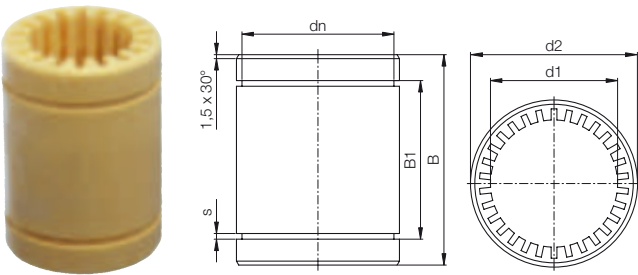

Order key

RJM-01-08

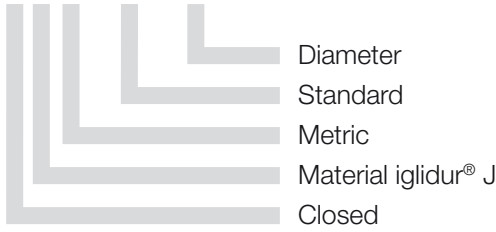

- Dimension equivalent to the standard for recirculating ball bearings
- Assembly by pressfitting
► Press-in forces: see table



* according to igus® testing method ► page 1035
** design standards ► page 982
*** applies by room temperature pressfit decreases with time depending on the temperature
Please note: Installation instructions ► page 983

Technical Data

Part number	Shaft Ø [mm]	Tolerance* for d1 E9 [mm]	F max. dyn.** P = 2.5 MPa [N]	F max. stat.** P = 17.5 MPa [N]	Weight [g]	Pressfit force [N]
RJM-01-08	8	+0.025 +0.061	250	1,750	4	400
RJM-01-10	10	+0.032 +0.075	363	2,538	7	700
RJM-01-12	12	+0.032 +0.075	480	3,360	9	1,300
RJM-01-16	16	+0.032 +0.075	720	5,040	13	1,100
RJM-01-20	20	+0.040 +0.092	1,125	7,875	24	1,500
RJM-01-25	25	+0.040 +0.092	1,813	12,688	47	3,500
RJM-01-30	30	+0.040 +0.092	2,550	17,850	72	4,500
RJM-01-40	40	+0.050 +0.112	4,000	28,000	127	4,200

Dimensions [mm]

Part number	d1	d2	B	B1	s	dn
RJM-01-08	8	16	25	16.2	1.10	15.2
RJM-01-10	10	19	29	21.6	1.30	17.5
RJM-01-12	12	22	32	22.6	1.30	20.5
RJM-01-16	16	26	36	24.6	1.30	24.2
RJM-01-20	20	32	45	31.2	1.60	29.6
RJM-01-25	25	40	58	43.7	1.85	36.5
RJM-01-30	30	47	68	51.7	1.85	43.5
RJM-01-40	40	62	80	60.3	2.15	57.8

Can be combined with:



RQA-04



RTA-04



RGAS-04



RGA-04



delivery from stock
time



prices price list online
www.igus.co.uk/en/drylinR

Standard type, precise



Order key

RJMP-01-06

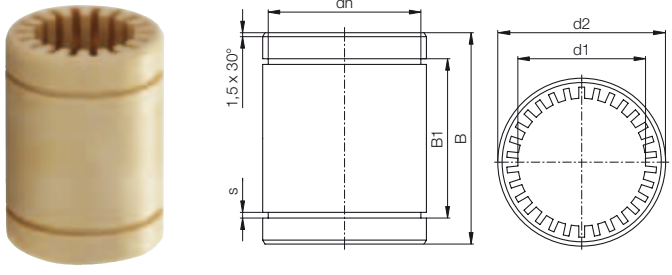
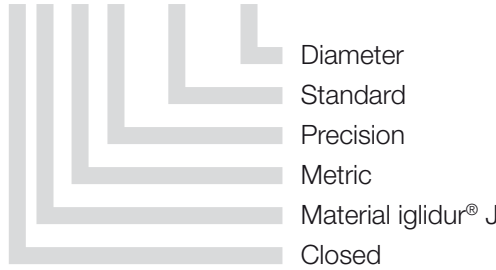

- Easy assembly by soft pressfit
- Reduced bearing clearance



* according to igus® testing method ► page 1035
** design standards ► page 982
Please note: Installation instructions ► page 983

Technical Data

Part number	Shaft Ø [mm]	Tolerance* für d1 [mm]	F max. dyn.** P = 2.5 MPa [N]	F max. stat.** P = 2.5 MPa [N]	Weight [g]
RJMP-01-06	6	+0.000 +0.030	200	1,400	2
RJMP-01-08	8	+0.000 +0.040	250	1,750	4
RJMP-01-10	10	+0.000 +0.040	363	2,538	7
RJMP-01-12	12	+0.000 +0.040	480	3,360	9
RJMP-01-16	16	+0.000 +0.040	720	5,040	13
RJMP-01-20	20	+0.000 +0.040	1,125	7,875	24
RJMP-01-25	25	+0.000 +0.050	1,813	12,688	47
RJMP-01-30	30	+0.000 +0.050	2,550	17,850	72

Dimensions [mm]

Part number	d1	d2	B	B1	s	dn
RJMP-01-06	6	12	19	13.5	1.10	11.5
RJMP-01-08	8	16	25	16.2	1.10	15.2
RJMP-01-10	10	19	29	21.6	1.30	17.5
RJMP-01-12	12	22	32	22.6	1.30	20.5
RJMP-01-16	16	26	36	24.6	1.30	24.2
RJMP-01-20	20	32	45	31.2	1.60	29.6
RJMP-01-25	25	40	58	43.7	1.85	36.5
RJMP-01-30	30	47	68	51.7	1.85	43.5

Can be combined with:



RQA-04



RTA-04



RGAS-04



RGA-04



delivery from stock
time



prices price list online
www.igus.co.uk/en/drylinR